

3253/S-TR

3253/C-TR

PORTALAMPADE A COLONNA PER LAMPADE FLUORESCENTI LINEARI T8-T12 TOMBSTONE LAMPHOLDERS FOR T8-T12 FLUORESCENT LINEAR LAMPS

Dati tecnici

Technical data



- Attacco lampada - Lamp cap	G13
- Corrente e tensione nominale - Rated current and voltage	2A-500V 2A-250V (.../C-...)
- Temperatura massima di funzionamento (IEC) - Maximum operating temperature (IEC)	T140 Tm110
- Grado di protezione - Protection index	IP20
- Categoria di sovratensione - Impulse withstand category	II

Caratteristiche

Characteristics

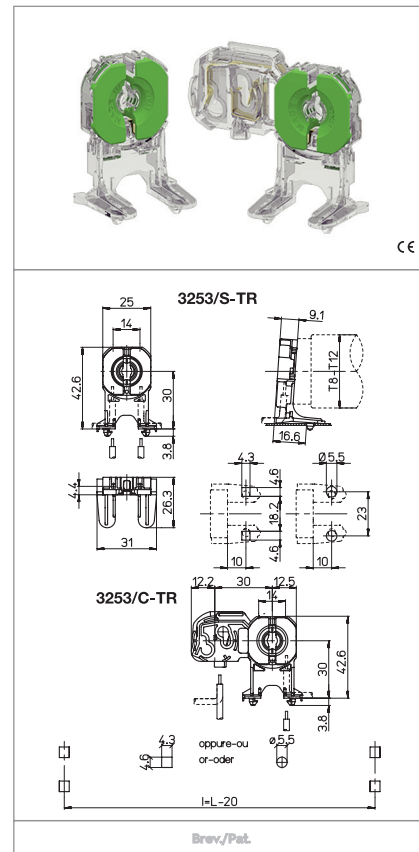
- Corpo in policarbonato trasparente
- Transparent polycarbonate body
- Contatti in lega di rame
- Copper alloy contacts
- Con top test
- With top test

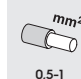
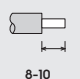

 <p>fissaggio ad innesto push-in fixing</p>	 <p>spessore lamiera di fissaggio fixing metal plate thickness 0,6-1</p>	 <p>altezza centro lampada (da sopra la lamiera) lamp centre height (from the top of the metal plate) 30</p>	 <p>rotore in PBT con scatti di... PBT green rotor with position of... 90°</p>
 <p>serrafilo automatico a 2 fori push-wire terminals with 2 holes</p>	 <p>sezione conduttore rigido rigid conductor section mm² 0,5-1</p>	 <p>spelatura cavetti rigidi rigid wires stripping 8-10</p>	 <p>IP40 nei punti d'aggancio IP40 in the hooking points</p>

Marchi di qualità

Quality marks

   660W-600V HT120 (UL496)

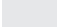
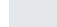
Direttive Europee

European directives

Conforme "RoHS"
"RoHS" compliant
Non soggetto alla "RAEE"
Not subject to "WEEE"

Pesi e confezioni

Weights and packaging

Art. Codice prodotti Product references	g Peso netto Net weight	n° pz per sacco per bag	n° pz per scatola per box	n° pz per cartone per carton
3253/S-TR	5,7	500		
3253/C-TR	8,4	500		

Note

Notes