

**401/V**

**LAMPENFASSUNG FÜR KOMPAKTSTOFFLAMPEN (TC-S)**  
**LAMPHOLDER FOR COMPACT FLUORESCENT LAMPS (TC-S)**

**Technische Daten**

*Technical data*





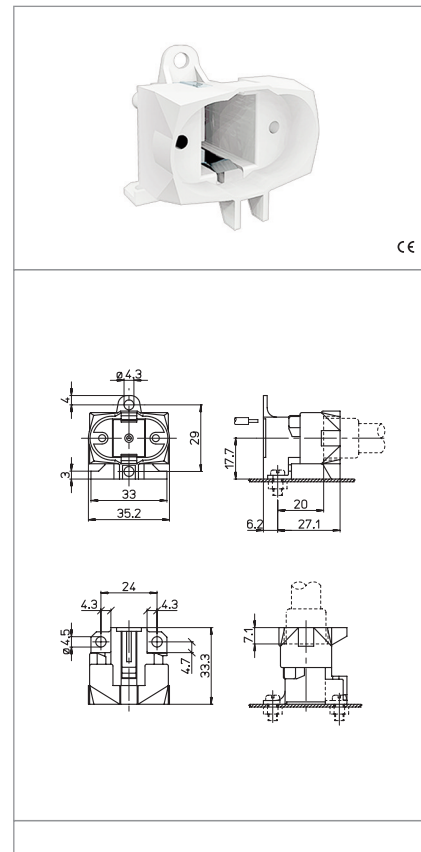

- LAMPENSOCKEL - Lamp cap	<b>G23</b>
- Nennstrom und Nennspannung - Rated current and voltage	<b>2A-250V</b>
- Maximale Betriebstemperatur (IEC) - Maximum operating temperature (IEC)	<b>T140</b>
- Schutzgrad - Protection index	<b>IP20</b>
- Überspannungskategorie - Impulse withstand category	<b>III</b>

**Merkmale**

*Characteristics*

- Gehäuse aus PBT, weiss  
- White PBT body
- Kupferlegierte Kontakte  
- Copper alloy contacts

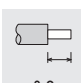

 Schraubbefestigung screw fixing	 Lichtpunkthöhe ab Oberfläche Leuchtenblech lamp centre height (from the top of the metal plate) 17,7	 Steckkontakte mit 1 Loch push-wire terminals with 1 hole	 Feste Leitungsabschnitte rigid conductor section mm <sup>2</sup> 0,5-1
 Leitungsabsolierung rigid wires stripping 8-9	 130		

**Prüfzeichen**

*Quality marks*

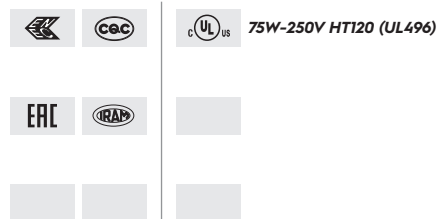

**Europäische Richtlinien**

*European directives*

gemäß "RoHS"  
"RoHS" compliant  
unterliegt nicht "WEEE"  
Not subject to "WEEE"

**Gewichte und Verpackung**

*Weights and packaging*

Artikel/Art. Produktinweise Product references	g Nettogewicht Net weight	n° pz pro Beutel per bag	n° pz pro Box per box	n° pz pro Karton per carton
401/V	11,4	500	200	

**Bemerkung**

*Notes*