

461/V-3

LAMPENFASSUNG FÜR KOMPAKTSTOFFLAMPEN (TC-L) LAMPHOLDER FOR COMPACT FLUORESCENT LAMPS (TC-F)

Technische Daten

Technical data





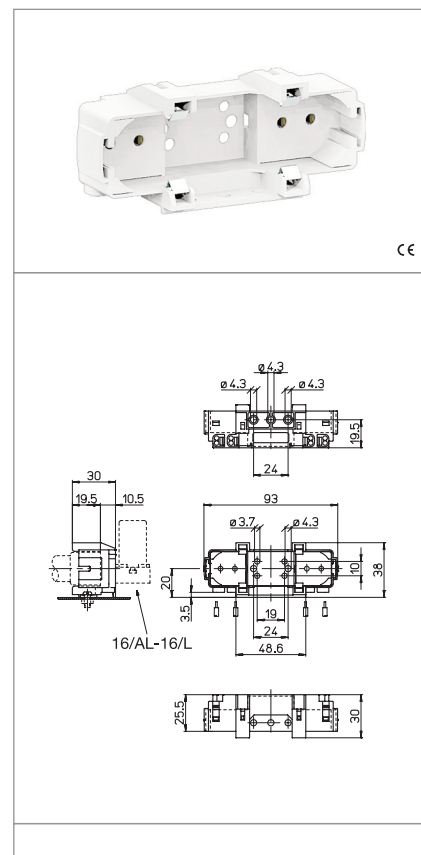

- LAMPENSOCKEL - Lamp cap	2G10
- Nennstrom und Nennspannung - Rated current and voltage	2A-250V
- Maximale Betriebstemperatur (IEC) - Maximum operating temperature (IEC)	T140
- Schutzgrad - Protection index	IP20
- Überspannungskategorie - Impulse withstand category	III

Merkmale

Characteristics

- Gehäuse aus PBT, weiss
- White PBT body
- Kupferlegierte Kontakte
- Copper alloy contacts

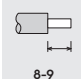

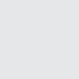
 Schraubbefestigung screw fixing	 Lichtpunkthöhe ab Oberfläche Leuchtenblech lamp centre height (from the top of the metal plate)	 Steckkontakte mit 2 Löchern push-wire terminals with 2 holes	 Feste Leitungsabschnitte rigid conductor section
 Leitungsabsolierung rigid wires stripping	 20	 120	 mm ² 0,5-1

Prüfzeichen Quality marks

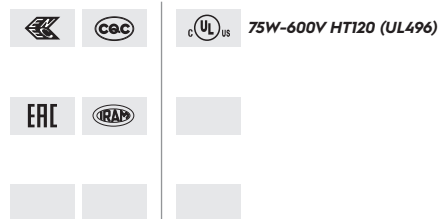

Europäische Richtlinien European directives

gemäß "RoHS"
"RoHS" compliant
unterliegt nicht "WEEE"
Not subject to "WEEE"

Gewichte und Verpackung Weights and packaging

Artikel/Art. Produktinweise Product references	g Nettogewicht Net weight	n° pz pro Beutel per bag	n° pz pro Box per box	n° pz pro Karton per carton
461/V-3	26,7		50	

Bemerkung

Notes