

442/AU

LAMPENFASSUNG FÜR KOMPAKTSTOFFLAMPEN (TC-S) LAMPHOLDER FOR COMPACT FLUORESCENT LAMPS (TC-L)

Technische Daten

Technical data





- LAMPENSOCKEL - Lamp cap	2G11
- Nennstrom und Nennspannung - Rated current and voltage	2A-250V
- Maximale Betriebstemperatur (IEC) - Maximum operating temperature (IEC)	T140
- Schutzgrad - Protection index	IP20
- Überspannungskategorie - Impulse withstand category	III

Merkmale

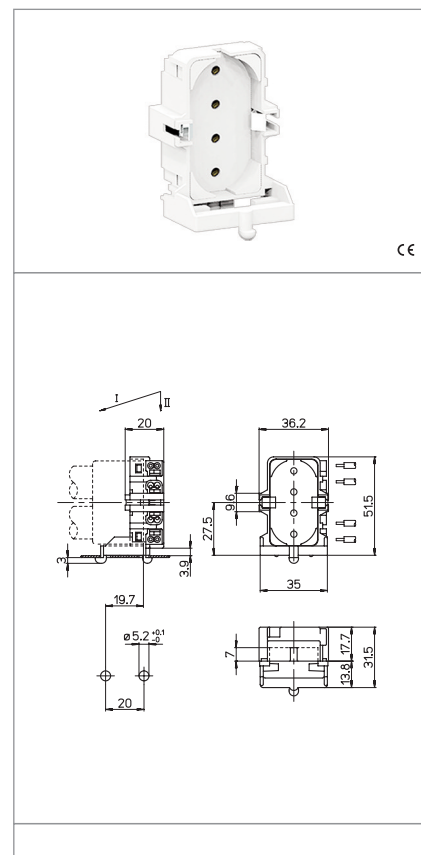
Characteristics

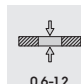
- Gehäuse aus PBT, weiss
– White PBT body
- Kupferlegierte Kontakte
– Copper alloy contacts

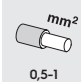
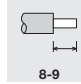

 Einteckbefestigung push-in fixing	 Blechstärke zur Befestigung fixing metal plate thickness 0,6-1,2	 Lichtpunkthöhe ab Oberfläche Leuchtenblech lamp centre height (from the top of the metal plate) 27,5	 Steckkontakte mit 2 Löchern push-wire terminals with 2 holes
 Feste Leitungsabschnitte rigid conductor section 0,5-1	 Leitungsabsisolierung rigid wires stripping 8-9	 131	 120

Prüfzeichen

Quality marks

   660W-600V HT120 (UL496)

Europäische Richtlinien

European directives

gemäß "RoHS"
"RoHS" compliant
unterliegt nicht "WEEE"
Not subject to "WEEE"

Gewichte und Verpackung

Weights and packaging

Artikel/Art. Produktinweise Product references	g Nettogewicht Net weight	n° pz pro Beutel per bag	n° pz pro Box per box	n° pz pro Karton per carton
442/AU	18,7	500	100	

Bemerkung

Notes