



## M/82

Ghiera in termoplastico per M/302 e M/302/T8.  
*Thermoplastic shade ring for M/302 and M/302/T8.*

Codice articolo  
*Article code*

**M/82/N**



1000

1,6

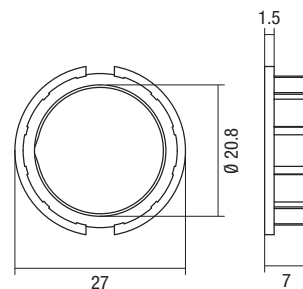

## 5031/A G4 - GX5,3 - G6,35 - GY6,35 - 8A 24V T250

Corpo in steatite - Morsetti automatici - Contatti in bronzo nichelato - Fori fissaggio 4,5 mm.

*Steatite body - Push in terminals - Nickel bronze contacts - Fixing holes 4,5 mm.*

Codice articolo  
*Article code*

**5031/A/B**



1000

4,3

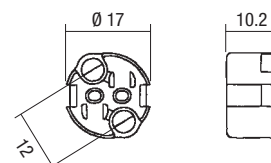

## 5031/AV G4 - GX5,3 - G6,35 - GY6,35 - 8A 24V T250

Corpo in steatite - Morsetti automatici - Contatti in bronzo nichelato - Fori filettati per fissaggio con vite M3.

*Steatite body - Push in terminals - Nickel bronze contacts - Threaded holes for screw fixing M3.*

Codice articolo  
*Article code*

**5031/AV/B**



1000

6,0

