

402/L

402/LD

**LAMPENFASSUNG FÜR KOMPAKTSTOFFLAMPEN (TC-S)**  
**LAMPHOLDER FOR COMPACT FLUORESCENT LAMPS (TC-S)**

**Technische Daten**  
Technical data





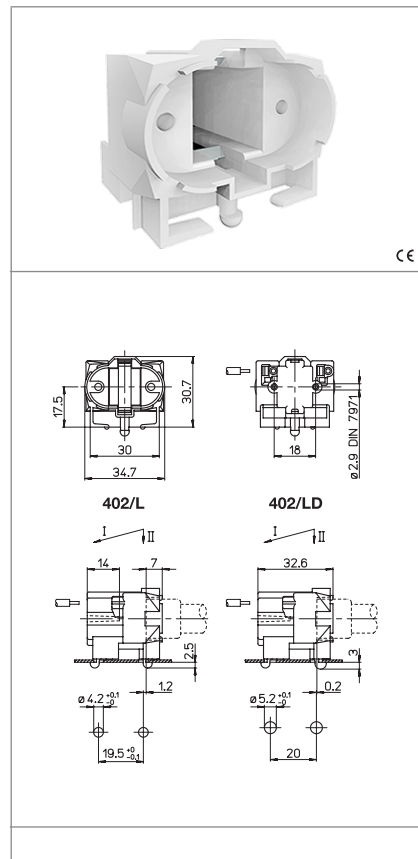

- Lampensockel - Lamp Cap	G23
- Nennstrom und Nennspannung - Rated current and voltage	2A-250V
- Maximale Betriebstemperatur (IEC) - Maximum operating temperature (IEC)	T140
- Schutzgrad - Protection index	IP20
- Überspannungskategorie - Impulse withstand category	III

**Merkmale**

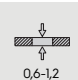
Characteristics

- Gehäuse aus PBT, weiss  
- White PBT body
- Kupferlegierte Kontakte  
- Copper alloy contacts

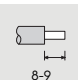

 Einteckbefestigung push-in fixing	 Blechstärke zur Befestigung fixing metal plate thickness 0,6-1,2	 Lichtpunkthöhe ab Oberfläche Leuchtenblech lamp centre height (from the top of the metal plate) 17,5	 Steckkontakte mit 1 Loch push-wire terminals with 1 hole
 Feste Leitungsabschnitte rigid conductor section 0,5-1 mm <sup>2</sup>	 Leitungsabsolierung rigid wires stripping 8-9	 130	

**Prüfzeichen**  
Quality marks

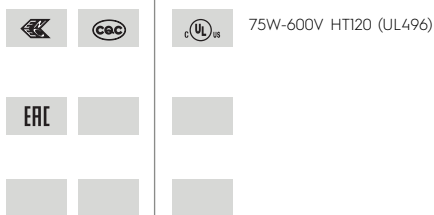

**Europäische Richtlinien**  
European directives

Gemäß "RoHS"  
"RoHS" compliant  
Unterliegt nicht "WEEE"  
Not subject to "WEEE"

**Gewichte und Verpackung**  
Weights and packaging

Art. Codice prodotti Product references	g Peso netto Net weight	n° pz per sacco per bag	n° pz per scatola per box	n° pz per cartone per carton
402/L	11,5	500	200	
402/LD	11,4	500		

**Bemerkung**

Notes

<b>402/L 402/LD</b>						<b>404/BU</b>					
G23	2A-250V	T140				G23	2A-250V	T140			
<b>PORTALAMPADE IP20</b> – Corpo in PBT – Contatti in lega di rame			<b>402/L</b> <b>402/LD</b>			<b>PORTALAMPADE IP20</b> – Corpo in PBT – Contatti in lega di rame			<b>404/BU</b>		
<b>IP20 LAMP HOLDERS</b> – PBT body – Copper alloy contacts						<b>IP20 LAMP HOLDER</b> – PBT body – Copper alloy contacts					
 0,6-1,2			 17,5			 0,5-1			 8-9		
 mm <sup>2</sup>			 8-9			 130					
<b>402/A 402/B</b>						<b>403/LR</b>					
G23	2A-250V	T140				G23	2A-250V	T140			
<b>PORTALAMPADE IP20</b> – Corpo in PBT – Contatti in lega di rame			<b>402/A</b> <b>402/B</b>			<b>PORTALAMPADE IP20</b> – Corpo in PBT – Contatti in lega di rame			<b>403/LR</b>		
<b>IP20 LAMP HOLDERS</b> – PBT body – Copper alloy contacts						<b>IP20 LAMP HOLDER</b> – PBT body – Copper alloy contacts					
 0,6-1			 17,5			 0,5-1			 8-9		
 mm <sup>2</sup>			 8-9			 130					
<b>1403/LR</b>						<b>1403/LR-T</b>					
G23	2A-250V	T140				G23	2A-250V	T140			
<b>PORTALAMPADE IP20</b> – Corpo in PBT – Contatti in lega di rame			<b>1403/LR</b>			<b>PORTALAMPADE IP20</b> – Corpo in PBT – Contatti in lega di rame			<b>1403/LR-T</b>		
<b>IP20 LAMP HOLDER</b> – PBT body – Copper alloy contacts						<b>IP20 LAMP HOLDER</b> – PBT body – Copper alloy contacts					
 0,6-1			 17,5			 0,5-1			 8-9		
 mm <sup>2</sup>			 8-9			 130			 10-11		