

# LED Electrical Specification for **G5RT15WXXXLRP**

Phase Dimmable LED Driver

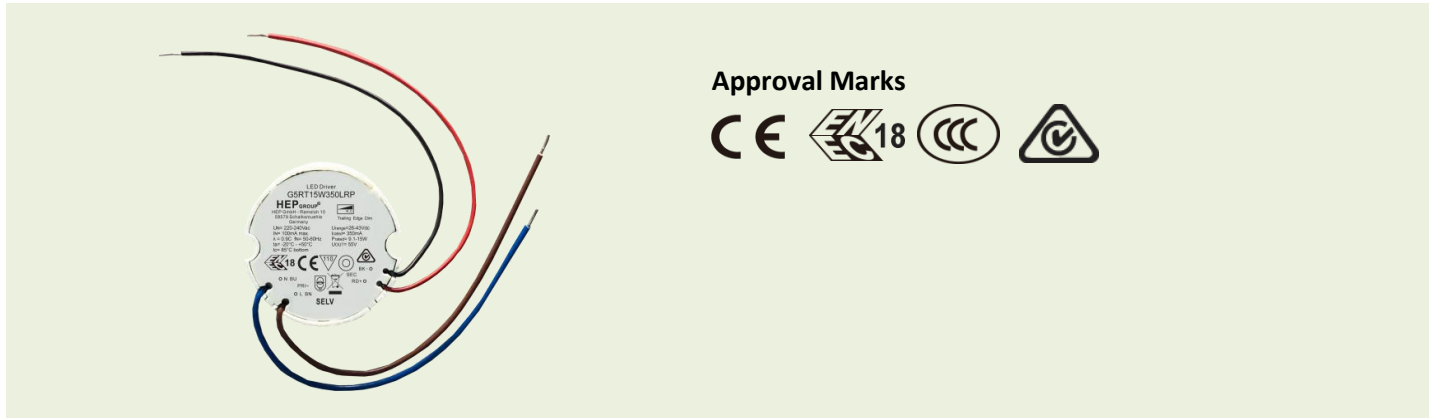

Item	Value	Remark
Nominal voltage	220–240V	
Nominal frequency	50–60Hz	
AC voltage range	198–264V	
DC voltage range (start)	NA	
DC voltage range (operation)	NA	
Maximum voltage	264Vac	2 h maximum.unit might not operate in this abnormal condition
Nominal current		
G5RT15W300LRP	90mA	
G5RT15W350/500/700LRP	100mA	
Total Harmonic Distortion (THD)	< 20%	Full load @230VAC
Power factor	0.9C	Full load @230VAC
Displacement factor	0.9C	Full load @230VAC
Efficiency		
G5RT15W300/350/500LRP	80%(Typ.)	Full load @230VAC
G5RT15W700LRP	78%(Typ.)	Full load @230VAC
No-load power	NA	
Stand-by power	NA	
Protection class	NA	
Inrush current	14A / 8.5us	
Earth leakage current	NA	
Nominal voltage range		
G5RT15W300LRP	26-43Vdc	
<b>G5RT15W350LRP</b>	26-43Vdc	
G5RT15W500LRP	18-30Vdc	
G5RT15W700LRP	13-21Vdc	
Maximum voltage		
G5RT15W300LRP	55Vdc	
<b>G5RT15W350LRP</b>	55Vdc	
G5RT15W500LRP	38Vdc	
G5RT15W700LRP	28Vdc	

	Item	Value	Remark	
Output	Nominal current range			
	G5RT15W300LRP	300mA		
	<b>G5RT15W350LRP</b>	350mA		
	G5RT15W500LRP	500mA		
	G5RT15W700LRP	700mA		
	Current accuracy	± 5%	Full load @230VAC	
	Typical output LF current ripple	± 5%	Low Frequency< 120Hz Full load @230VAC	
	SVM	≤0.4	Full load @230VAC	
	P <sub>stLM</sub>	≤1	Full load @230VAC	
	Dimming	Nominal power range		
G5RT15W300LRP		7.8-12.9W		
<b>G5RT15W350LRP</b>		9.1-15W		
G5RT15W500LRP		9-15W		
G5RT15W700LRP		9.1-14.7W		
Maximum power		15.05W		
Dimming control		Trailing Edge		
Dimming technique		Amplitude		
PWM frequency		NA		
Dimming range		10-100%		
Environment	Lowest dimming current	2-6%		
	Galvanic isolation	NA		
	Ambient temperature range t <sub>a</sub>	-20°C - +50°C		
	Maximum case temperature t <sub>c</sub>	85 °C	bottom	
	Max. case temp. in fault condition	110°C	When operating under fault conditions, the temperature of the enclosure at any location should not exceed 110 °C	
	Storage temperature range	-40°C - +85°C		
	Relative humidity	10% - 95%		
	Surge transient protection	1 kV	L/N	
	Environmental rating	Indoor		
	IP rating	IP20		
Packing	Mains switching cycles	> 100,000		
	Expected lifetime	> 50,000 h, t <sub>c</sub> 85 °C @ t <sub>a</sub> 50 °C > 100000 h, t <sub>c</sub> 75 °C @ t <sub>a</sub> 40 °C	0.2 % / 1,000 h failure rate 0.1 % / 1,000 h failure rate	
	Gross weight/box	14.2 kg		
	Net weight/box	13.2 kg		
	Pcs/box	180 PCS		
	Dimension/box	385(L)*310(W)*260(H)mm		
	<b>Protections</b>			
	Short- & open circuit proof, Auto. overheat regulation or cut off, Overload protection			
	<b>Conformity &amp; Standards</b>			
	Safety standard:	EN 61347-1, EN 61347-2-13, EN 62493		
Performance:	EN 62384			
EMC standard:	EN 55015, EN 61000-3-2, EN 61000-3-3, EN 61547			

**Cable information**

<b>PRI</b> Connection	L	N
Color	Brown	Blue
Wire type	7022	7022
Wire diameter	AWG20	AWG20
Wire length	140mm	140mm
Stripping	6mm	6mm
Tolerance	±5mm	±5mm

<b>Sec</b> Connection	+	-
Color	Red	Black
Wire type	1332	1332
Wire diameter	AWG22	AWG22
Wire length	139mm	139mm
Stripping	6mm	6mm
Tolerance	±5mm	±5mm

\*Subject to change without notice, HEP guarantees all products perform functionally well\*

\* If not mentioned, all the test conditions are based on full load at 230VAC input (for 220-240 VAC input).

**Trailing Edge Dimmer list approved by HEP**

Manufacturer	Model	Q'ty of parallelconnection
BUSCH-JAEGER	6523 UR-103	16
BUSCH-JAEGER	6523 U-102	16
Niko	310-0190X	8
JUNG	LB-Management	4
Merten	SBD200LED(MEG5134-0000)	8
AU	P3	10
Philips	SED-200A	11
Merten/Schneider	SBD315RC	15
Etman	ETM327	15
Etman	ETM329	15

**Electrical Values**

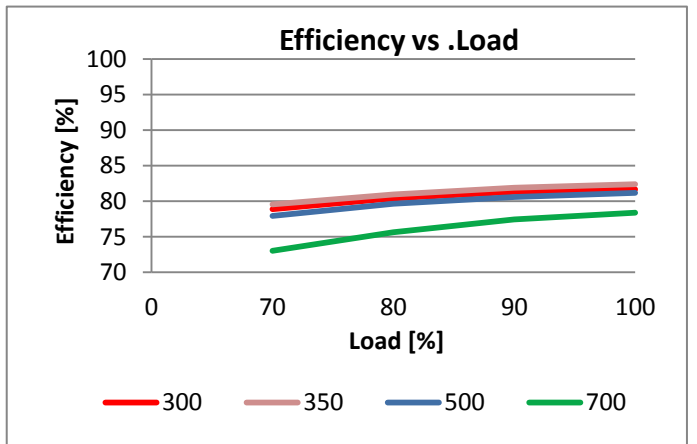
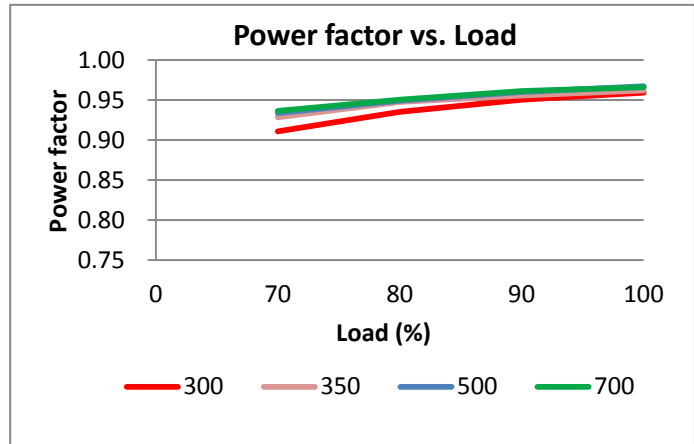
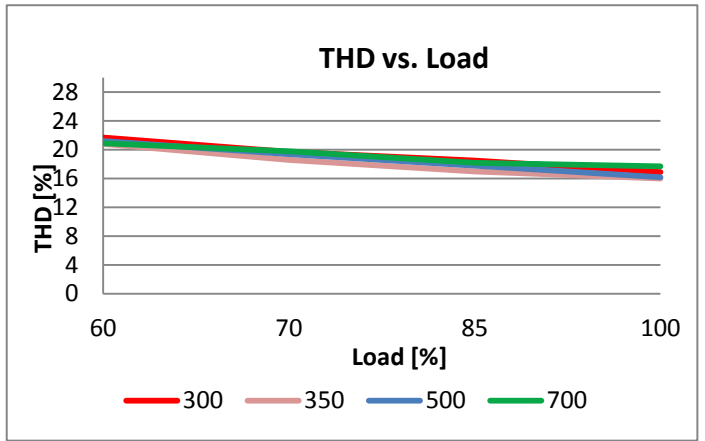
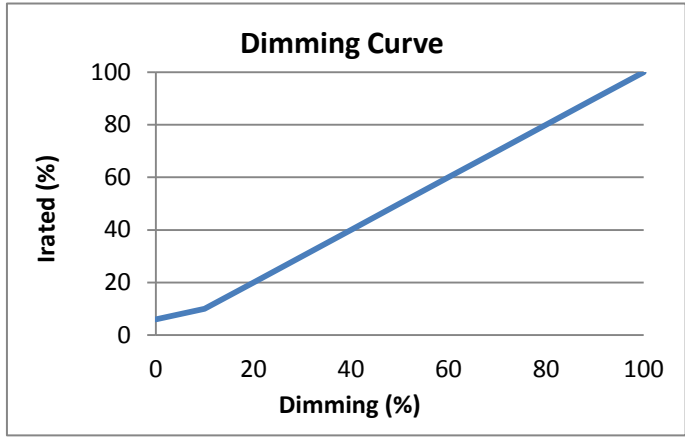

**Physical  
Parameter**

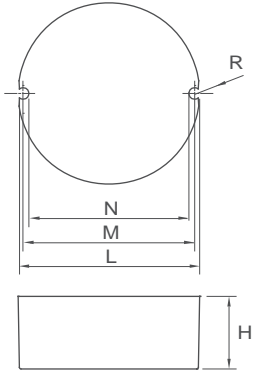

L : 48 mm    M : 46.7 mm    N : 43.5 mm

H : 25 mm    R : 1.6 mm

Tolerance : +/-1 mm , R : +/-0.5 mm

Housing Material : Polycarbonate / Potting  
 Soldering : Lead-Free, Comply With RoHS  
 Label : Surface Print

**Wiring Diagram**

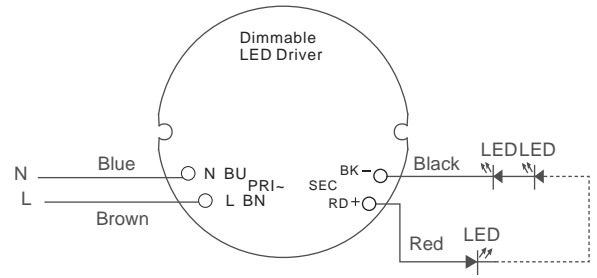

**TC location (Bottom)**

