

LED Electrical Specification for G5RT15WXXXLRP

Phase Dimmable LED Driver

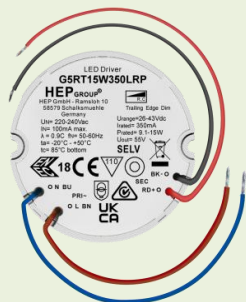

Approval Marks



Item	Value	Remark
Nominal voltage	220–240V	
Nominal frequency	50–60Hz	
AC voltage range	198–264V	
DC voltage range (start)	NA	
DC voltage range (operation)	NA	
Nominal current		
G5RT15W300LRP	90mA	
G5RT15W350/500/700LRP	100mA	
Total Harmonic Distortion (THD)	< 20%	Full load @230VAC
Power factor	0.9C	Full load @230VAC
Displacement factor	0.9C	Full load @230VAC
Efficiency		
G5RT15W300/350/500LRP	80%(Typ.)	Full load @230VAC
G5RT15W700LRP	78%(Typ.)	Full load @230VAC
No-load power	NA	
Stand-by power	NA	
Protection class	NA	
Inrush current	14A / 8.5us	
Max.units per circuit breaker	Type B , 10A MCB	40
	Type B , 16A MCB	64
	Type C , 10A MCB	50
	Type C , 16A MCB	80
Earth leakage current	NA	
Nominal voltage range		
G5RT15W300LRP	26-43Vdc	
G5RT15W350LRP	26-43Vdc	
G5RT15W500LRP	18-30Vdc	
G5RT15W700LRP	13-21Vdc	
Maximum voltage		
G5RT15W300LRP	55Vdc	
G5RT15W350LRP	55Vdc	
G5RT15W500LRP	38Vdc	
G5RT15W700LRP	28Vdc	

	Item	Value	Remark
	Nominal current range		
	G5RT15W300LRP	300mA	
	G5RT15W350LRP	350mA	
	G5RT15W500LRP	500mA	
	G5RT15W700LRP	700mA	
	Current accuracy	± 5%	Full load @230VAC
Output	Typical output LF current ripple	± 5%	Low Frequency < 120Hz Full load @230VAC
	SVM	≤ 0.4	Full load @230VAC
	P _{stLM}	≤ 1	Full load @230VAC
	Nominal power range		
	G5RT15W300LRP	7.8-12.9W	
	G5RT15W350LRP	9.1-15W	
	G5RT15W500LRP	9-15W	
	G5RT15W700LRP	9.1-14.7W	
	Maximum power	15.05W	
Dimming	Dimming control	Trailing Edge	
	Dimming technique	Amplitude	
	PWM frequency	NA	
	Dimming range	10-100%	
	Lowest dimming current	2-6%	
	Galvanic isolation	NA	
	Ambient temperature range t _a	-20°C - +50°C	
	Maximum case temperature t _c	85 °C	bottom
	Max. case temp. in fault condition	110°C	When operating under fault conditions, the temperature of the enclosure at any location should not exceed 110 °C
Environment	Storage temperature range	-40°C - +85°C	
	Relative humidity	10% - 95%	
	Surge transient protection	1 kV	L/N
	Environmental rating	Indoor	
	IP rating	IP20	
	Mains switching cycles	> 100,000	
	Expected lifetime	Full Load > 50,000 h, t _c 85 °C @ t _a 50 °C ≤ 70% Full load > 48,000 h, t _c 85 °C @ t _a 60 °C	0.2 % / 1,000 h failure rate 0.21 % / 1,000 h failure rate
Packing	Gross weight/box	14.2 kg	
	Net weight/box	13.2 kg	
	Pcs/box	180 PCS	
	Dimension/box	385(L)*310(W)*260(H)mm	
Protections			
	Short-circuit Protection	Auto recovery	
	Open-circuit Protection	Auto recovery	
	Overload Protection	Auto recovery	
Conformity & Standards			
	Safety standard:	EN 61347-1, EN 61347-2-13, EN 62493	
	Performance:	EN 62384	
	EMC standard:	EN 55015, EN 61000-3-2, EN 61000-3-3, EN 61547	

Cable information

PRI Connection	L	N
Color	Brown	Blue
Wire type	7022	7022
Wire diameter	AWG20	AWG20
Wire length	140mm	140mm
Stripping	6mm	6mm
Tolerance	±5mm	±5mm

Sec Connection	+	-
Color	Red	Black
Wire type	1332	1332
Wire diameter	AWG22	AWG22
Wire length	139mm	139mm
Stripping	6mm	6mm
Tolerance	±5mm	±5mm

Subject to change without notice, HEP guarantees all products perform functionally well

* If not mentioned, all the test conditions are based on full load at 230VAC input (for 220-240 VAC input).

Trailing Edge Dimmer list approved by HEP

Manufacturer	Model	Q'ty of parallelconnection
BUSCH-JAEGER	6523 UR-103	16
BUSCH-JAEGER	6523 U-102	16
Niko	310-0190X	8
JUNG	LB-Management	4
Merten	SBD200LED(MEG5134-0000)	8
AU	P3	10
Philips	SED-200A	11
Merten/Schneider	SBD315RC	15
Etman	ETM327	15
Etman	ETM329	15
CASAMBI	CBU-TED	6

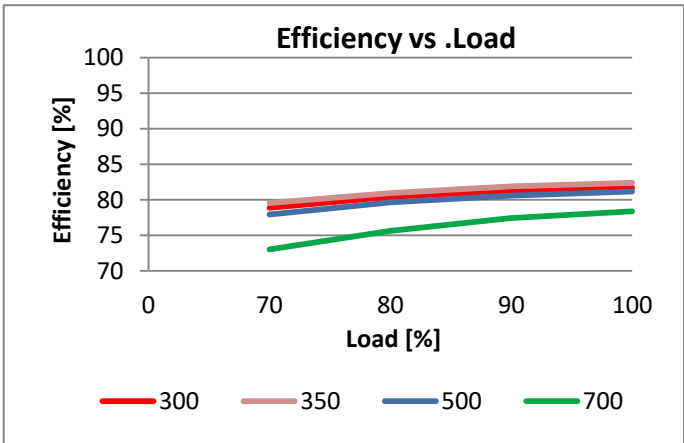
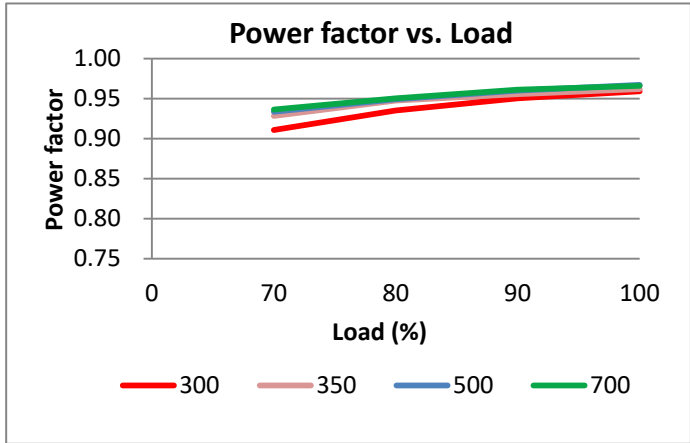
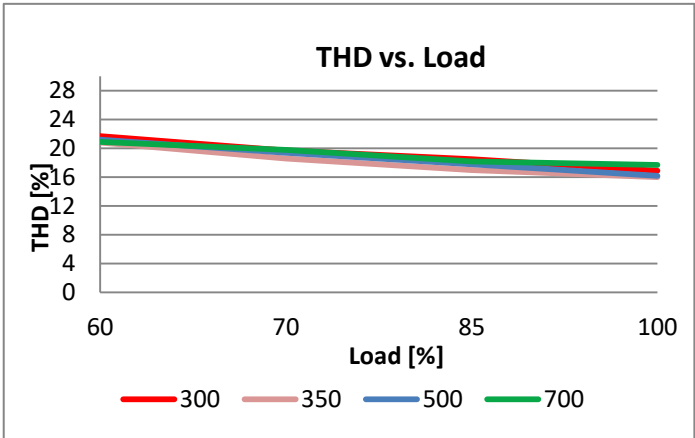
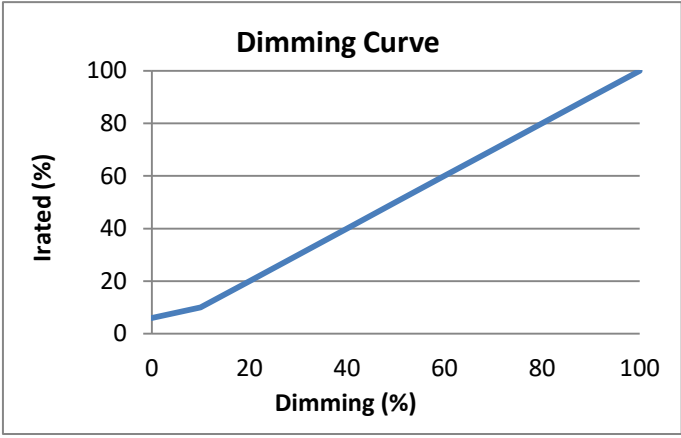

**Physical
Parameter**

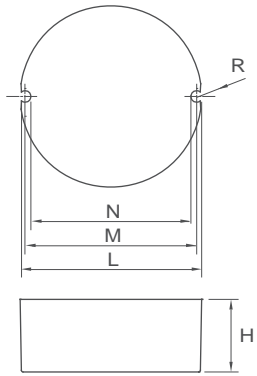

L : 48 mm M : 46.7 mm N : 43.5 mm
 H : 25 mm R : 1.6 mm

Tolerance : +/-1 mm , R : +/-0.5 mm

Housing Material : Polycarbonate / Potting
 Soldering : Lead-Free, Comply With RoHS
 Label : Surface Print

Wiring Diagram

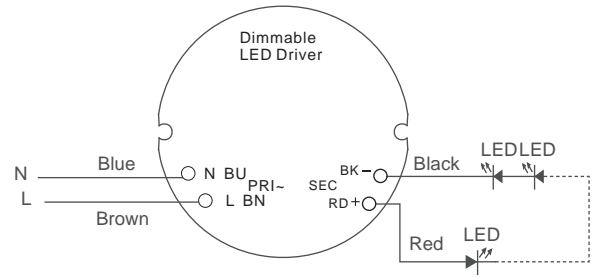

TC location (Bottom)

